

SLIMBox Series

Wall Mounted 19"
Racks W=640mm
(SLIM design)



SLIMBox Series - Wall Mounted 19" Racks W=640mm (SLIM design)

Wall Mounted 19" SLIMbox Cabinets Allow Vertical Mounting for Space Efficiency and Aesthetics. Used for Networking, Security, DVR, Sound, Paging and Patching Applications. Suitable for any 19" Active Devices.

Features :

- Securely locking hinged body.
- 23" (654mm) useable equipment depth (vertical)
- Available in two racking heights : 4U and 6U space.
- Punched knockouts in the backpan with plastic cover for cable entry:
 - Top and bottom – 145 x 70 mm
 - Right and left – 145 x 70 mm
- Punched knockouts in body of backpan with plastic cover for cable entry 145 x 70 mm
- One bottom located fan mounting position with guard. (fan not included).
- Vented front for cooling.
- The rack rail can be used both for vertical or horizontal directions. Adjustable front rack rail provides 20"-23" useable equipment depth vertically and A"-B" horizontally.
- Available with solid metal front door, or with plexi window on top. Front door swing is reversible.
- Available in a durable texture electrostatic powder paint
 - 70-90µm thickness
 - 500 hours of Salt Spray test resistance
 - Adhesion capability EN ISO 2409 : Class 0 to 1
 - RAL7035 or RAL9005
- Max. Loading capacity: 100 kg

Standarts :

- ISO 9001:2008
- TSE:EN 61587-1 Mechanical Structures For Electronic Equipment - Tests For IEC 60917 And IEC 60297
- Climatic and Environment: EN 61587-1/4.2, IEC60068-2-1, IEC60068-2-2, IEC60068-2-30,
- Static Mechanical Load Lifting: EN61587-1/5.2.1
- Static Mechanical Load Stiffness: EN61587-1/5.2.2
- Dynamic Mechanical Load Vibration and Shock , Impact: EN61587-1/5.3.1, EN61587-1/5.3.3, IEC60068-2-6, IEC60068-2-27,
- Earth Bond: EN61587-1/6.2
- Flammability: EN61587-1/6.3
- Degrees Of Protection Provided By Enclosures (Ip Code): IP20, EN61587-1/6.4



SLIMBox Series - Wall Mounted 19" Racks W=640mm (SLIM design)

Wall Mounted 19" SLIMbox Cabinets Allow Vertical Mounting for Space Efficiency and Aesthetics. Used for Networking, Security, DVR, Sound, Paging and Patching Applications. Suitable for any 19" Active Devices.

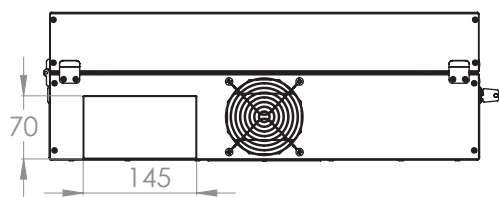

BOTTOM VIEW

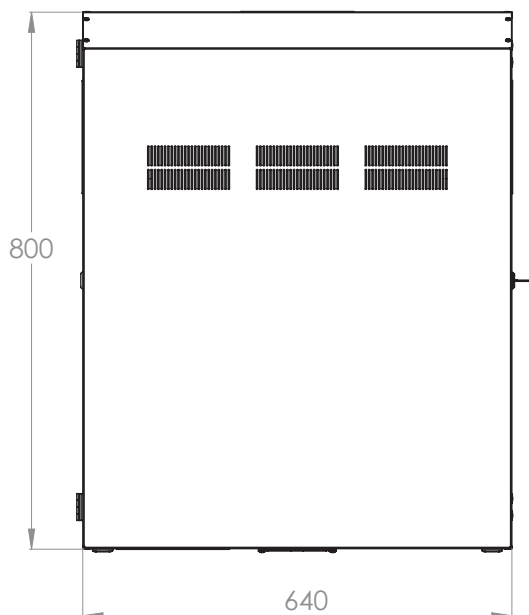

FRONT VIEW

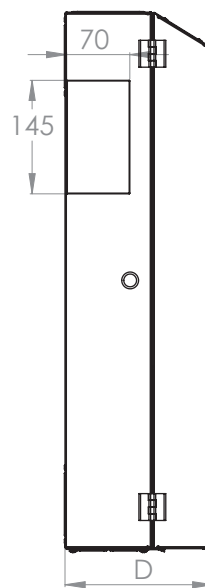

SIDE VIEW

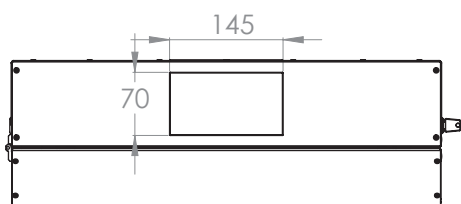

TOP VIEW

SLIMBox Series - Wall Mounting 19" Racks W=640mm (SLIM design)

Catalog Code	Series	Product Description	Width (W mm)	Depth (D mm)	Height (H mm)	Cable Entry (pcs)	Lock (pcs)	Hinge (pcs)
LN-WM SLM 4U S-CC	SlimBOX	4U 19" Wall Mounting - Solid metal front door	640	220	800	6	1	2
LN-WM SLM 6U S-CC	SlimBOX	6U 19" Wall Mounting - Solid metal front door	640	309	800	6	1	3

** CC= Color Code please define while ordering the color code as LG Light Grey RAL 7035, BL Black RAL 9005

SLIMBox Series - Wall Mounted 19" Racks W=640mm (SLIM design)

Wall Mounted 19" SLIMbox Cabinets Allow Vertical Mounting for Space Efficiency and Aesthetics. Used for Networking, Security, DVR, Sound, Paging and Patching Applications. Suitable for any 19" Active Devices.

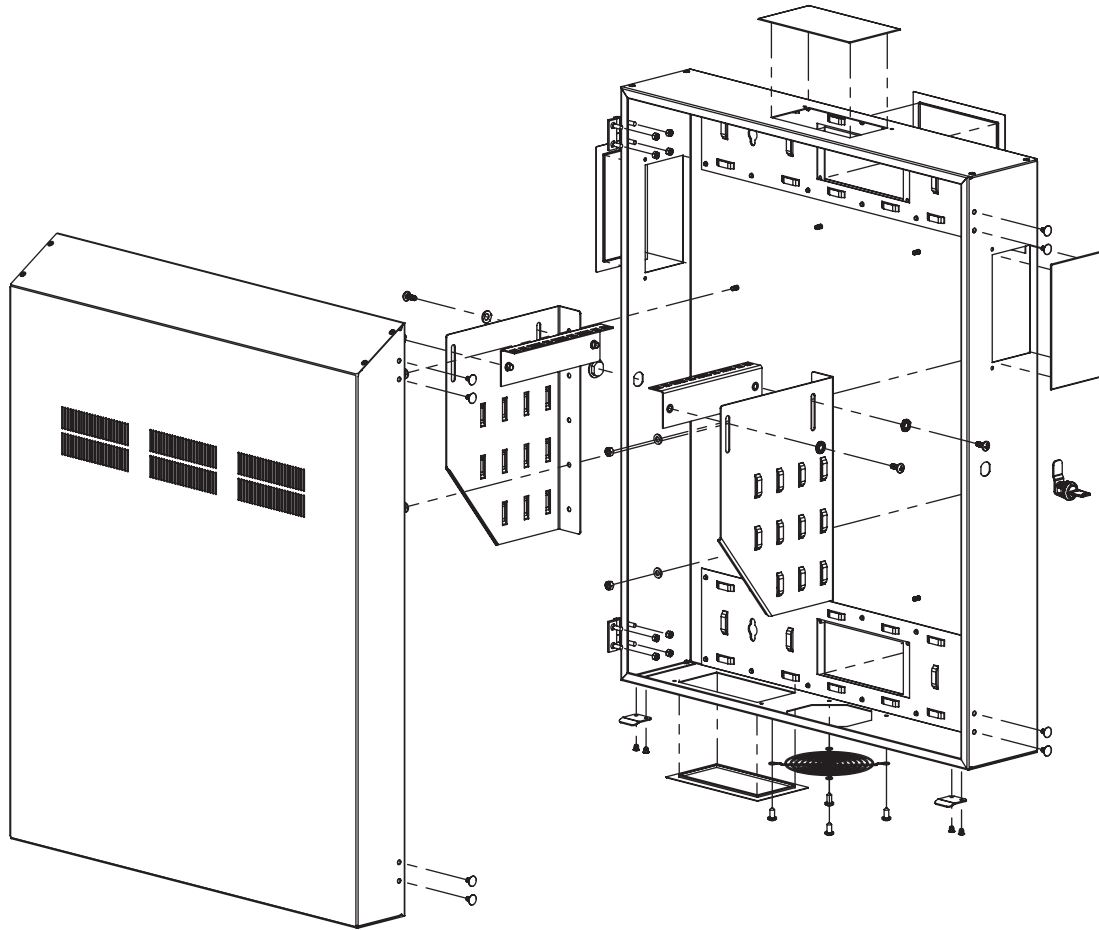

EXPLODED VIEW

Shipping Configuration			
Part Definition	Material Quality	Material Thickness (mm)	Shipment Configuration
Main body (Structure)	DIN EN 10130-DC-01-6112 CRS	1	1
Door	DIN EN 10130-DC-01-6112 CRS	1	1
19" Rack rail bracket	DIN EN 10130-DC-01-6112 CRS	1,5	2
19" Rackrail	DIN EN 10130-DC-01-6112 CRS	1,5	2
Cable mounting bracket	DIN EN 10130-DC-01-6112 CRS	1	2
Plexi cover	Mechanical charecteristics and stroke ISO 527-1,-2, ISO179-1	2	1

SLIMBox Series - Wall Mounted 19" Racks W=640mm (SLIM design)

Wall Mounted 19" SLIMbox Cabinets Allow Vertical Mounting for Space Efficiency and Aesthetics. Used for Networking, Security, DVR, Sound, Paging and Patching Applications. Suitable for any 19" Active Devices.

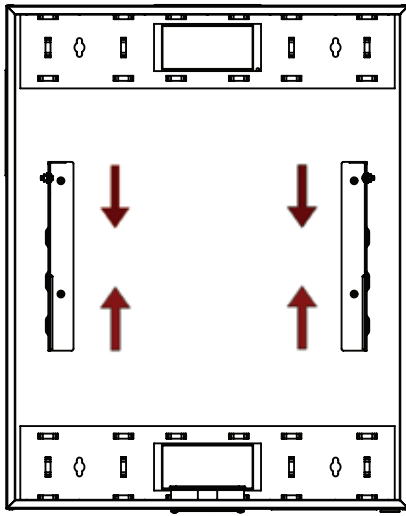

OPSİYON 1

Front View Backpan – Vertical Equipment Assembly 60mm sliding up-down

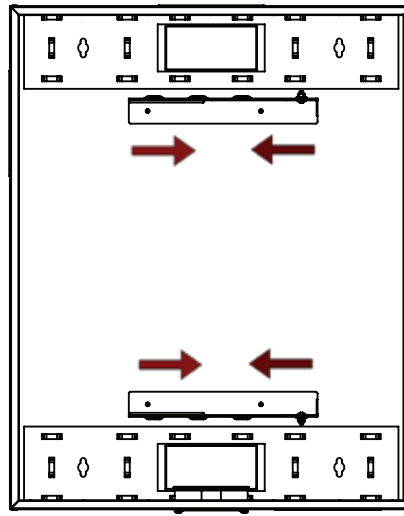

OPSİYON 2

Front View Backpan – Horizontal Equipment Assembly 60mm sliding top-down

Rack rails can be easily mounted either vertical or horizontal. This option allows to have more space inside the rack for additional different equipment usage.

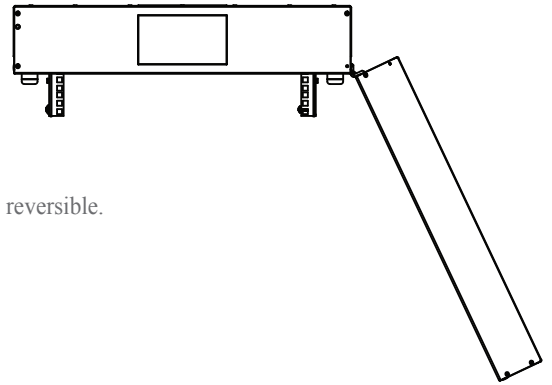
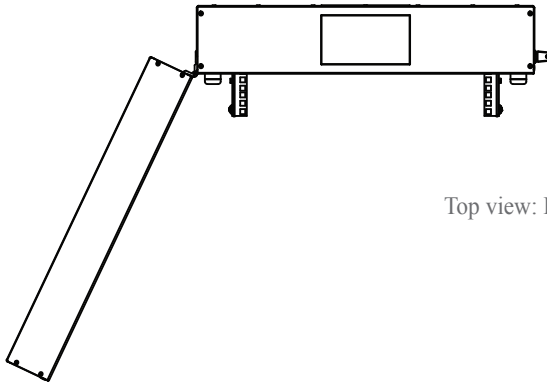

Top view: Front door swinging position is reversible.

Packaging :

The racks shall be packed with a cardboard box and placed on a wooden pallet (960x1300mm). Vertical corners are protected with 4 double bended cardboard sheets. Covered with stretch film and labelled.

SLIMBOX Series - Wall Mounting 19" Racks - W:640 mm (SLIM Design) - Packaging Details					
Catalog Code	Series	Product Description	Box Dimensions (HxWxD mm)	Pallet Dimensions (HxWxD mm)	Quantity on a pallet (pcs)
LN-WM SLM 4U S-CC	SlimBOX	4U 19" Wall Mounting - Solid metal Front door	820x660x230	1710x820x1320	14
LN-WM SLM 6U S-CC	SlimBOX	6U 19" Wall Mounting - Solid metal Front door	820x660x320	2010x820x1320	12

** CC= Color Code please define while ordering the color code as LG Light Grey RAL 7035, BL Black RAL 9005