



19" ANTIVANDAL THEFTproof Security IT Network CABINETS



W=600mm D=600mm ANTIVANDAL Series Wall Mounting Cabinets

Antivandal Security Wall Mounting Cabinets, are designed for Public areas under indoor conditions for higher security needs. Where it is providing IP20 protection, with Security/Resistance Level according to **DIN V ENV 1627 Level WK4**, which is a level provides 10 minutes protection against additional tools: Saws, power tools, e.g. hacksaw, battery drill, hammer, axe, etc. This protection level is called **High protection**.

Usage areas are Public areas and buildings, Military Services and Higher security needed Critical device housing applications.

CONSTRUCTION DETAILS:

t=2,5 and 3,0 mm thickness Steel material, is formed with double layer welding which provides 5-6mm protection in rear assembly footprint, as well with flange system in front 30 mm steel protection is performed. Monoblock welded enclosure case provides the higher security.

Surface is with electrostatic powder coated finish, with fine wrinkle RAL 7035 Light Grey Color.

7,9,12 U optional height stocked enclosures are introduced for customer selection with W=600mm D=600mm physical outer sizes.

Multi Folded Automated Bending technology applied monoblock heavy duty structure results to high load capacity of: 200 kgs nominal way. Mostly this loading capacity is related to the type of the wall and its strength.

Front door opening direction is set left to right in standard.



19" ANTIVANDAL Series Wall Mounting Cabinets



W:600mm D:600mm

Mechanical Locking



CONSTRUCTION DETAILS:

Front Door has 2 option of locking,

Option 1: Mechanical High Security Lock with Case: Steel.Galvanized.

Forend Plate and striking: Steel. Chrome plated.

Deadbolt: Steel. Three bars. Chrome plated. Three throws.

EN 12209

Option 2: Electronic Locking, with keypad, with master barrel key.

Password 4-6 digits

With master mechanic barrel key

With alarm and sound buzzer

Digital Display screen

Logs for defining the opening by key

External battery supply, at internal side of front door

Low battery alarm

Mechanic and Electrical Keypad Locking



Mechanical Locking View From Inside



Mechanic and Electrical Keypad Locking View From Inside



CONSTRUCTION DETAILS:

19" rails of Antivandal Series Wall mounting cabinets are with automated silk-screen U numbering, depends on size 1U to 12U, same from top to bottom or bottom to top results to same U height selection. No matter from where you have started counting. 19" rails are 4 fold bending surfaces, 1,5mm thickness provides the high load capacities. The 19" rails are made of steel with 8-12 micron zinc plating for corrosion resistance. 19" rails are adjustable in depth. For easy adjustment purpose, no need to detach the screws, just ease the screws and slide them in the channels on the top/bottom chassis bends.

- 2 pcs cable entry location each on top, bottom and sides, at 47mm diameter knock-out style, for PG36 Cable entry pats. The size of the cable entry pat allows passage of the plugs of the active devices of PDUs.
- On right side bottom and on left side top, there are ventilation louvers for passive convection heat removal from enclosure.
- Rear Wall Assembly holes are 4 pcs, which are on the double layer welded footprint for security assembly on the wall. Possible to use M8 Screws

All design features provide you strength and security purposes on the enclosure.



19" ANTIVANDAL Series Wall Mounting Cabinets



Width:600mm depth:600mm

Standard Colors:



RAL 7035 Light Grey

Load Capacity: 200 kgs.

Width:600mm
Depth:600mm

Standard Heights:

3 different U heights: 7U, 9U and 12U

Standards, and Compliances:



ISO 9001:2008
Quality Management System

EN 61587 -1:2012
Mechanical Structures for
Electronic Equipment

IEC 297-1, 19" mounting
IEC 297-2 Overall cabinet dimensions



CE conform to
EN 60950-1:2006
Information Technology
Equipment – Safety – Part-1-
General Requirements



Environment Friendly;
*ISO 14001 Environmental
Management System
*Environmental awareness
*RoHS compliancy
*% 100 Recyclable Material.

VV



19" ANTIVANDAL Series Wall Mounting Cabinets , with 19" w:600mm and d:600mm physical sizes, with max internal usable depth, and 3 different height available with 2 option of locking system in front door

Construction Details

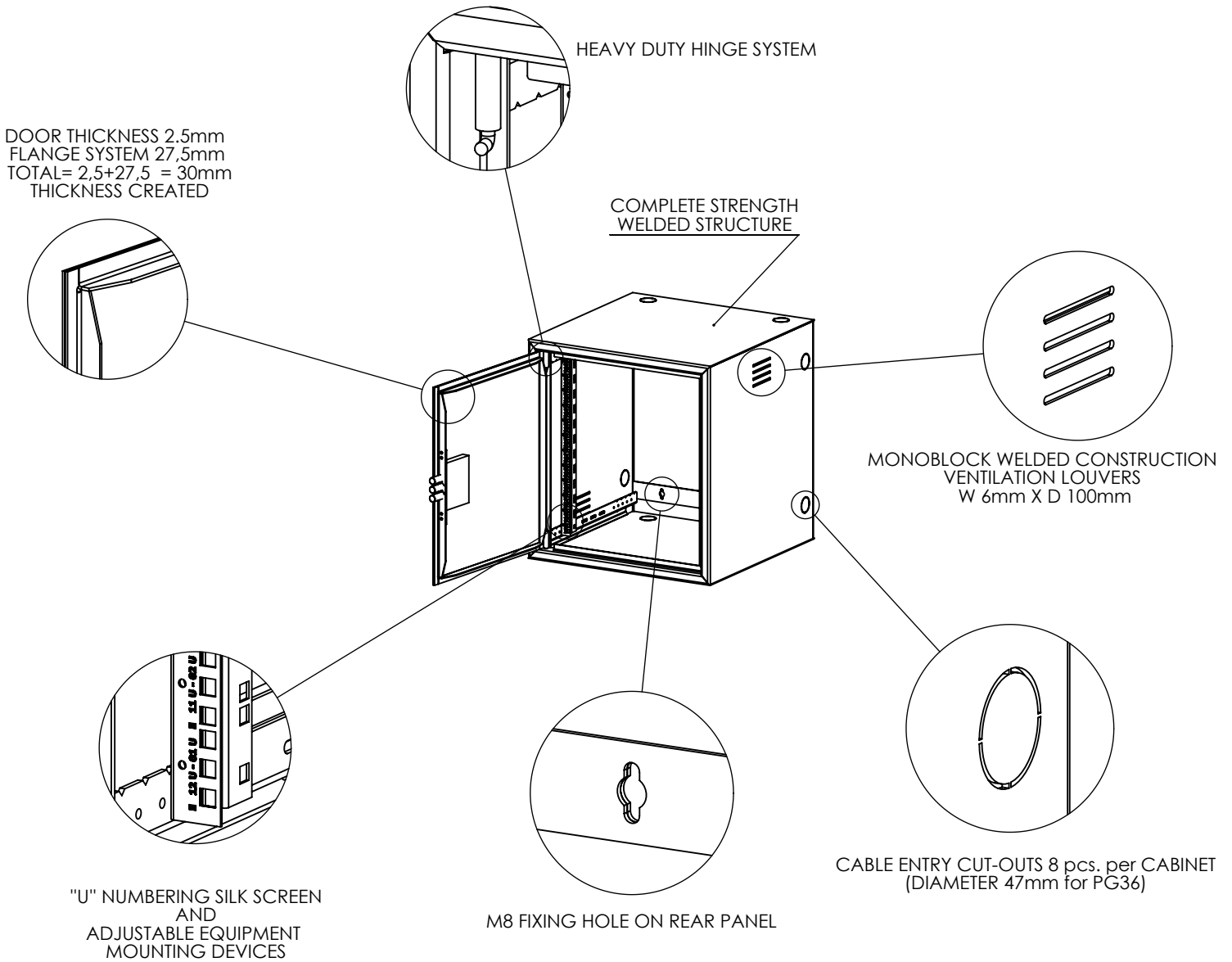

Locking System Options

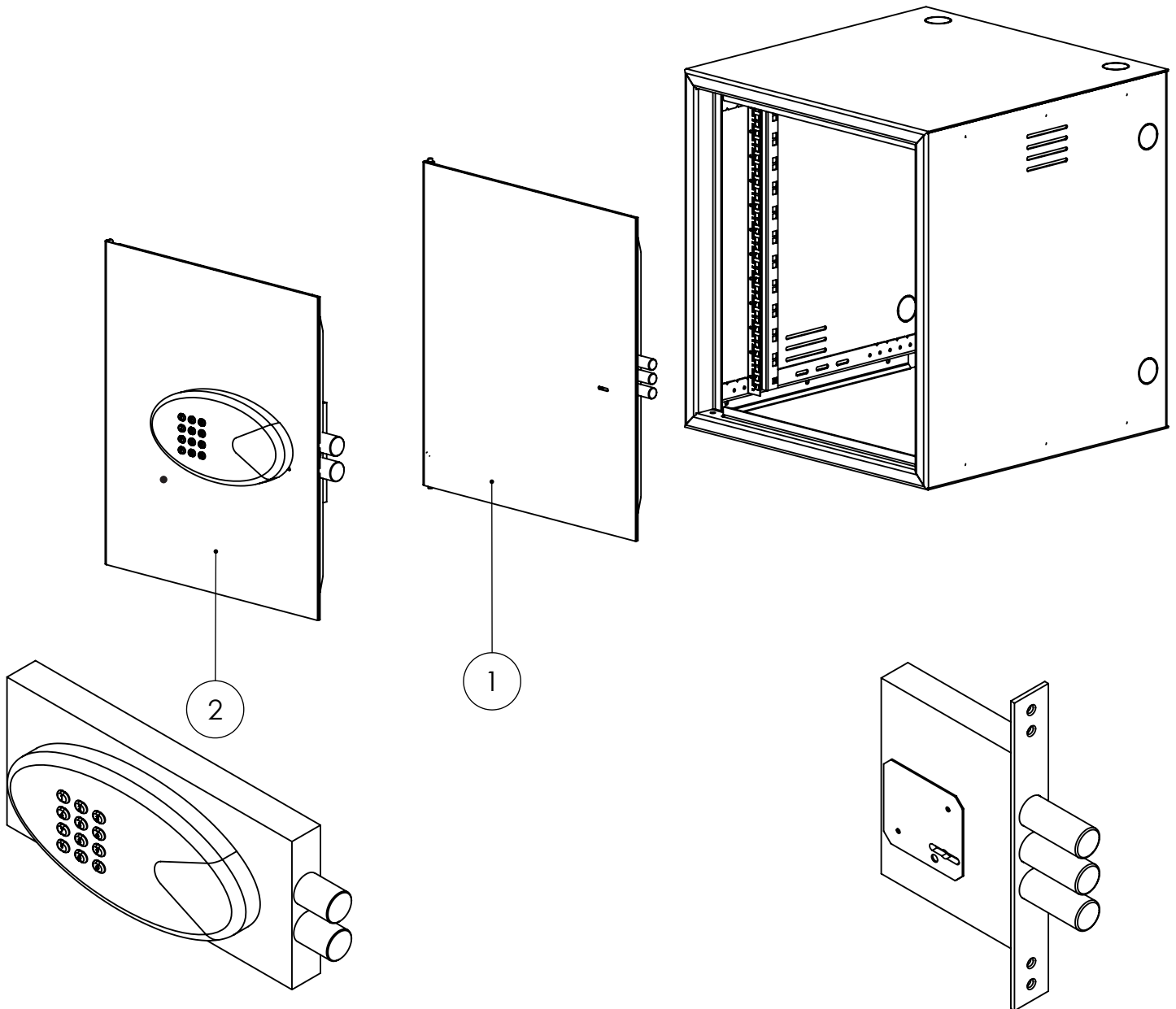

Electronic Locking, with keypad, with master barrel key.

Password 4-6 digits

With master mechanic barrel key

With alarm and sound buzzer

Digital Display screen

Logs for defining the opening by key

External battery supply, at internal side of front door

Low battery alarm

Mechanical High Security Lock with Case: Steel.Galvanized.

Forend Plate and striking: Steel. Chrome plated.

Deadbolt: Steel.

Three bars. Chrome plated.

Three throws.

EN 12209

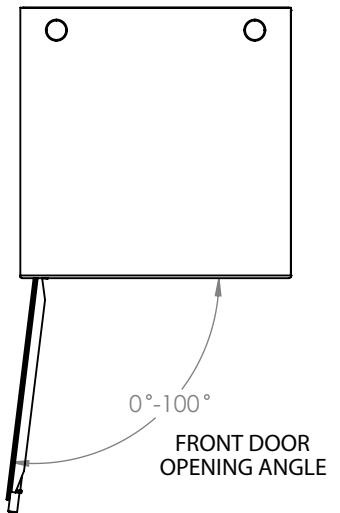
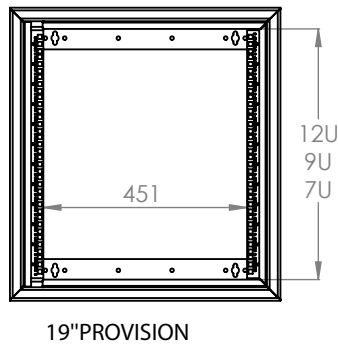
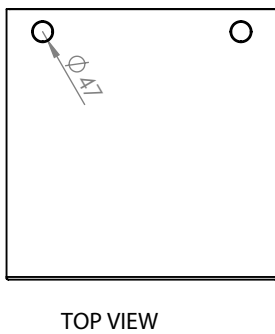
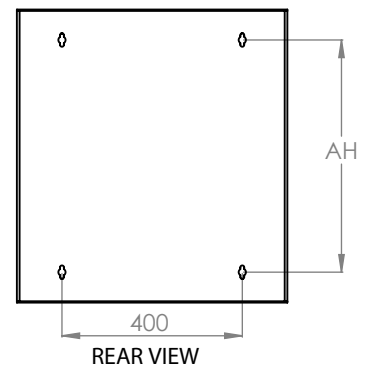
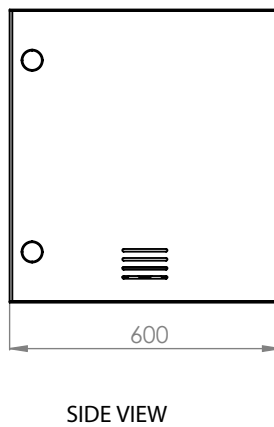
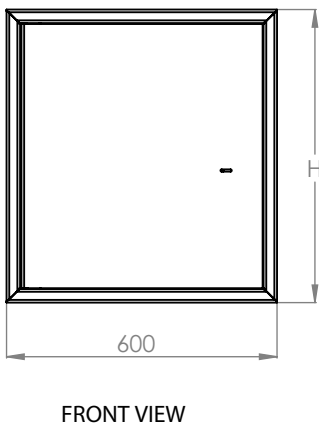
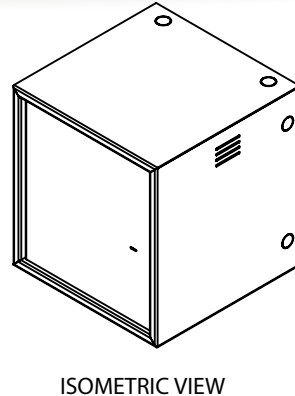
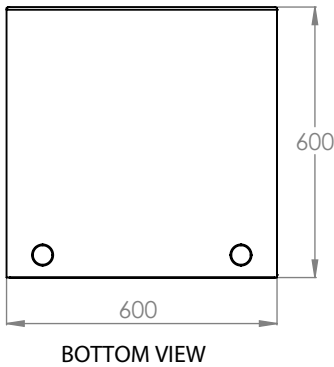

ANTIVANDAL Series Wall Mounting 19" Cabinets W=600mm D=600mm

Product Number	Product Description	Size WxDxH mm	HU size (U)	HU in mm	H mm, overall	AA Wall Fixing Hole Dimensions mm	Width Overall mm	Width Rail to Rail	Depth Overall mm	Depth Shipping Conf. Rail to Rail mm	QTY IN PACKAGE	PACKAGE DIMENSIONS WxDxH mm	Standard NET Weight of Product kgs	Gross Weight of Products kgs	QTY IN PALETTE	PALETTE DIMENSIONS WxDxH mm	Palette Weight kgs
LN-AV-07U6060-LG-1	7U 19" Wall Mounting Antivandal Cabinet W=600mm D=600mm RAL 7035 Light Grey	600x600x428	7U	311	428	290	600	19"	600	370	1	650x650x450	42	44	16	1320x1320x1950	718
LN-AV-09U6060-LG-1	9U 19" Wall Mounting Antivandal Cabinet W=600mm D=600mm RAL 7035 Light Grey	600x600x517	9U	400	517	380	600	19"	600	370	1	650x650x540	47	49	16	1320x1320x2350	814
LN-AV-12U6060-LG-1	12U 19" Wall Mounting Antivandal Cabinet W=600mm D=600mm RAL 7035 Light Grey	600x600x650	12U	533,4	650	515	600	19"	600	370	1	650x650x670	54	57	12	1320x1320x2160	714

* Standard Supply is in RAL 7035 light Grey Color, incase requested any other color please have a correspondence with your sales representative

** Standard Supply is with Mechanical Safety Locking, incase required with Electronic Lock with keypad, please replace 1 with 2 on the part number, ie, LN-AV-07U6060-LG-1 Mechanical Locking door, LN-AV-07U6060-LG-2 Electronic Locking Keypad controlled door.

*** Please select standard 19" accessories from main catalogue for this product range.