

# N E T b o x Wall Mounting C A B I N E T s



# 19" NETbox Wall Mounting Cabinets F A M I L Y

## W=600mm NETbox Series Wall Mounting Cabinets

NETbox series Networking Enclosures/ Cabinets, provide maximum optimization resulted to an optimum performance in between quality and added value.

While product gives maximum performance on cabling and networking infrastructure, in parallel provides a very respective economy compared to its quality which is based on high technologic fully automated industry.

The 600x450, 600x600 and D:150mm Rear Section Modules possible to integrate to d:450mm preferably and either to d:600mm. NETbox Wall Cabinet series is available in 5 heights from 7U through to 20U. Each cabinet is supplied as standard with a glass front door, mechanically screwed steel rear panel and lift off steel side panels, all of which are lockable.

The wide product height portfolio meets any U requirement in infrastructure needs.

NETbox series have a professional technical

but aesthetic look with decorative Aluminium Extruded Housing on the front door; the product range attracts the attention with the mostly environmentally fit and selected color of RAL 9005 Black, and RAL 7035 Light Grey, with fine wrinkle soft touch paint. Anthracite Grey Decorative ABS (Acrylonitrile Butadiene Styrene) material header Unit with art design on PVC provides an aesthetic visuality.

The product range allows with 150mm extension module integration where 4 way access is the question for wall applications.

Completely standard and stocked product portfolio, being delivered a single piece assembled product, as shipping configuration the one set: 2pieces 19" adjustable equipment mounting rails included.

NETbox Series product range with optimal panel mounting size, and a variety range of accessories enclose the whole expectation of users.



# 19" NETbox Wall Mounting Cabinets F A M I L Y

## CONSTRUCTION DETAILS:

Main Profile- Framework- Top/Bottom Cases, ABS Fan Housing:

Multi Folded Automated Bending technology applied corner profile system, provides a heavy duty structure results to high load capacity of: 80 kgs on wall.

Monoblock multi folded top and bottom cases 20 times bended resulted to a very heavy construction, tightly fixed to the framework with fixing hardware , fully modular system generated.

Top case has a ready Forced Ventilation (Fan Module) integration ABS housing. Fan Module installation can be operated either from roof or from internal side of cabinet.

The advantage of this system is, once the Fan Unit needs maintenance or replacement and while the cabinet is carrying integrated active and passive networking devices, than subject to remove some of them to replace the Fan Module Unit. Lande Cabinet Fan Module Unit access is from roof where no interference with the already installed components inside cabinets. Decorative Anthracite Grey ABS Fan Module integration housing replacement is toolless. Where the Fan Module to be inserted to the ABS Fan Module Housing without any tool.

Top case integrated with a cable entry point with rubber edged sliding mechanism with w:145mmx d:70mm allows proper cabling insertion. The rubber edged mechanism works between 0 to 50mm slide out.

After inserting the cables, the rubber edged mechanism holds and fixes the cables in parallel preventing the cabinet from dust entry.

Top Case, has ventilation slots at sides which provides passive air ventilation via convection. Once the cabinet is not equipped with forced ventilation ( Fan Units ), this ABS Fan Housing also provides passive ventilation via convection.

Top Case and Main Frame junctions are closed with Anthracite Grey PVC application for aesthetical appearance.

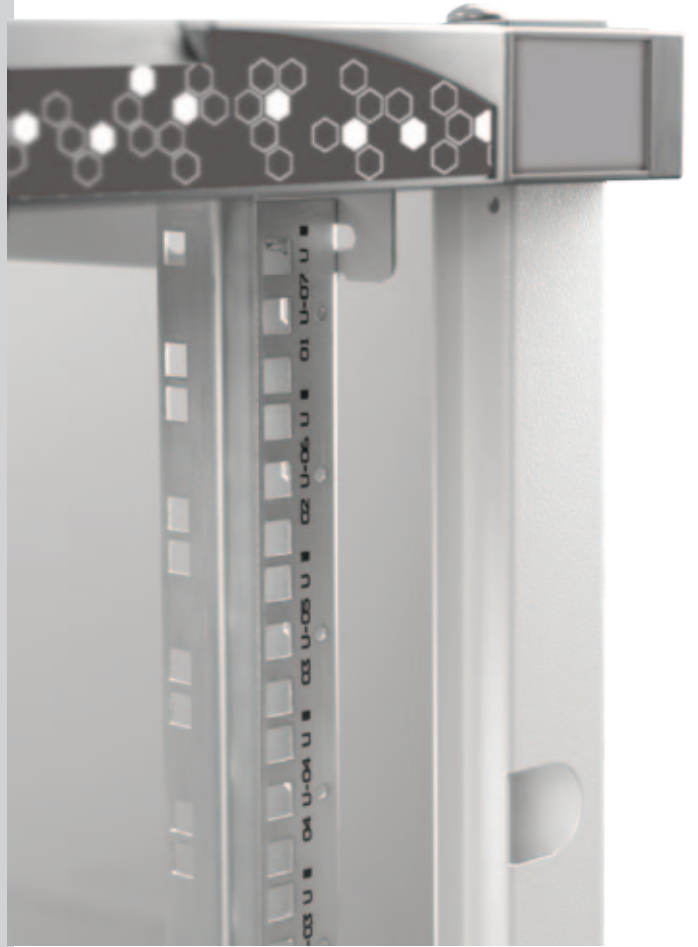

# 19" NETbox Wall Mounting Cabinets F A M I L Y

## CONSTRUCTION DETAILS:

Access to enclosure:

Front door is integrated with decorative 2,5mm thickness aluminium extruded frames, full length smoked , shatterproof, antistatic, 4,0mm thickness glass with single point locking barrel lock.

Front door Aluminium extruded frame allows , decorative PVC Stripes charming the attraction, Anthracite Grey for RAL 7035 Light Grey Cabinets and Light Grey for RAL 9005 Black cabinets

Front door opening direction is set right to left, but reversible to left to right at site with removing the hinge system. Hinge System is spring loaded easy operating version, which allows you to remove the whole front door from cabinet in seconds.

Alternative doors ( Curved Glass and Solid Metal) are available for customer selection. \*\*\* Please see door options at the end of each product size.

Side Panels are lockable and removable with barrel style lock, Multifolded bending technology with 8 fold bending provides the rigidity. Easy mechanical locking of panel to main frame with snap capture sytem allows easy attachment of panels and easy removal in seconds while installation in process.

Rear Panels are mechanically screwed to main module, which is Multifolded bending technology with 5 fold bending provided the rigidity.

Rear Panel can be used for wall fixing and drilling pattern.

Bottom case and Rear Panel integrated with PVC gland plate. Once needed gland plate and rubber edged sliding mechanism could be replaced on site

19" rails of Lande NETbox Series Wall cabinet are with automated silk-screen U numbering, depends on size 1U to 20U, same from top to bottom or bottom to top results to same U height selection. No matter where you have started counting from. 19" rails are 4 fold bending surfaces, 1,5mm thickness provides the high load capacities. The 19" rails are made of steel with 8-12 micron zinc plating for corrosion resistance. 19" rails are adjustable in depth. For easy adjustment purpose, no need to detach the screws, just ease the screws and slide them in the channels on the top/bottom chassis bends.

All design features provide 3 way access to your enclosure and equipments, easy to reach to enclosure and equipments for all infrastucture installations and maintenance needs.





# 19" NETbox Wall Mounting Cabinets F A M I L Y

## ADDITIONAL FEATURES:

NETbox Wall cabinets has an ABS Decorative header unit, where has a placement for the Digital Thermometer with 1 meter cable probe, integrated with 2 lithium battery with 2 year life, measurement once for every minute as accessory to be ordered.

NETbox Wall cabinets has sticky colour changing thermometer, range 20 to 40 C; as an accessory.

NETbox Wall Cabinets has a decorative ABS header unit. For volume orders or projects, please coordinate with sales department to select any other color application than Anthracite Grey standard offer by Lande.

Your company corporate colors are applicable!

NETbox Wall Cabinets have mechanically screwed rear panel. The panel can be used as wall fixing pattern on wall. This feature provides cost efficiency at site applications where a heavy enclosure to be fixed to wall. At least 2 technicians needed in standard. Lande NETbox cabinets are applicable with one technician at site only.

First the rear panel to be placed on wall for marking purposes, than drilling to be operated, finally the rear panel to be fixed on wall without the main cabinet unit.

Finally the cabinet to be hanged over the rear panel. For safety reasons the screwing must be completed. Without screws even cabinet safely should stay on wall.

NETbox wall cabinets offers one more advantage for site application, the internal active and passive components can be assembled to cabinet on the workshop. Afterwards wall fixation can be the process follows. Only the connection of the cables and power to be operated. This would be a big advantage for technicians while the Wall cabinet to be assembled to very high placements and locations especially in factory or warehouse conditions, where distribution infrastructure in cabinet to be completed at 4 to 8 meter high

Rear Panels are mechanically screwed to main module, which is Multifolded bending technology with 5 fold bending provided the rigidity.

Rear Panel can be used for wall fixing and drilling pattern.

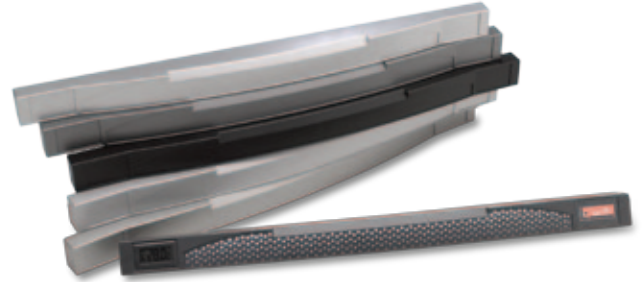

# 19" NETbox Wall Mounting Cabinets F A M I L Y

## ADDITIONAL FEATURES:

All Lande NETbox Wall Cabinets are proper to integrate with caster group or Adjustable leveling feet group. This feature provides a possibility of using wall cabinets as for free standing purposes, especially where the narrow places are the case. As well integration with caster group or PVC adjustable leveling feet group provides a possibility to use the cabinet for underdesk applications.

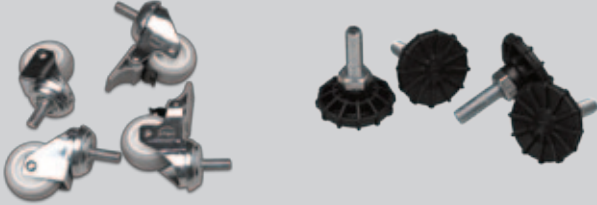

Please see detailed description in accesorry section.

Part numbers to order:

\*\*\* LN-ZMN-TKR-5020-XX for Caster Group Set

LN-ZMN-PNY-1040-XX for PVC Leveling Feet Group Set

Once using the Lande NETbox wall cabinets for Free standing purposes, and access from rear of the enclosure is mandatory request of integration, than please find the hinged rear door option instead of screwed panel option at the end of each product size.

Lande NETbox wall cabinets are being delivered with 1set: 2pcs 19" Rails.

Once a 4 point fixing shelf or any other 4 point fixing equipment to be installed, an additional set of 19" rails to be ordered. With this application it is possible to locate some deeper networking devices as well some heavy equipments like UPS's etc.

Part numbers to order:

\*\*\*LN-PRF-CMD-xx UD-ZN

Define xx as the U height of intended NETbox wall cabinet to be used

Example Part Nr: LN-PRF-CMD-07UD-ZN

Please see detailed description in accesorry section.

Lande NETbox wall cabinets are in RAL 7035 Light Grey color from stock.

Black RAL 9005 Color application is possible. Please co-ordinate with sales department of Lande for Black request especially for projects and concrete requests of customers.



Width=600mm  
Depth=600mm

Standard Heights:

5 different U heights:

07U, 09U, 12U, 16U, 20U

Standards, and Compliances:

**ISO 9001:2008**

Quality Management System

EN 61587 -1:2012

Mechanical Structures for  
Electronic Equipment

IEC 297-1, 19" mounting

IEC 297-2 Overall cabinet dimensions

**CE conform to**

EN 60950-1:2006

Information Technology  
Equipment – Safety – Part-1-  
General Requirements**Environment Friendly;**

\*Environmental awareness

\*RoHS compliancy

\*% 100 Recyclable  
Material**Load Capacity: 80 kgs.**

NETbox series Wall Mounting Networking Enclosures, with 19" w:600mm and d:600mm physical sizes, with max internal usable depth, and 5 different height, gives a wide selection chart for users.

All Lande NETbox Wall cabinets are being delivered as a single piece pre-assembled enclosure, with standard factory settings.

For Decoratively fitting to environment of your living areas, the cabinet has been integrated with highly modern, art fragrant parts and accessories.

For door and panel variations for different purpose of usage,

\*\*\* Please see door options at the end of each product size.

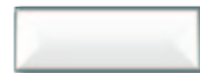
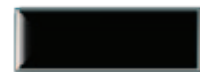
**Standard Color:**RAL 7035 Light Grey  
(Stock Delivery)**Optional Color:**

RAL 9005 Black

DETAILS ON  
EXPLODED VIEW

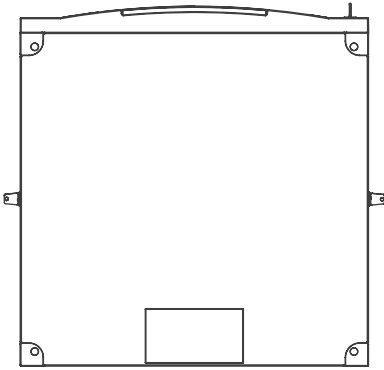

BOTTOM VIEW

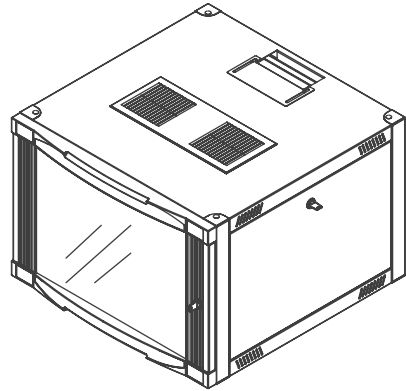

ISOMETRIC VIEW

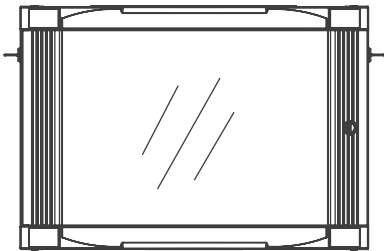

FRONT VIEW

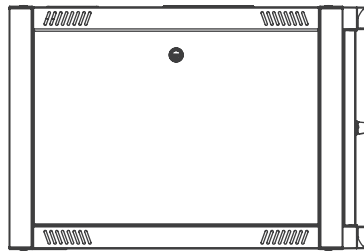

SIDE VIEW

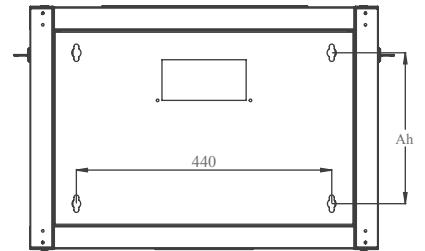

REAR VIEW

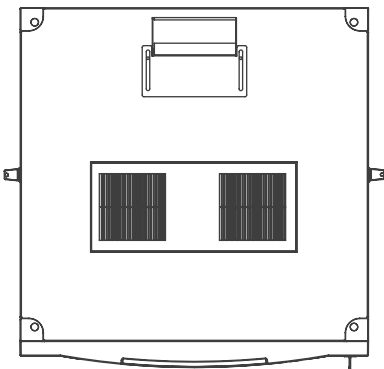

TOP VIEW

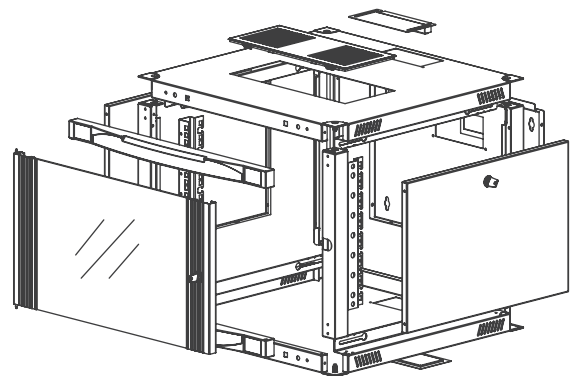

EXPLODED VIEW

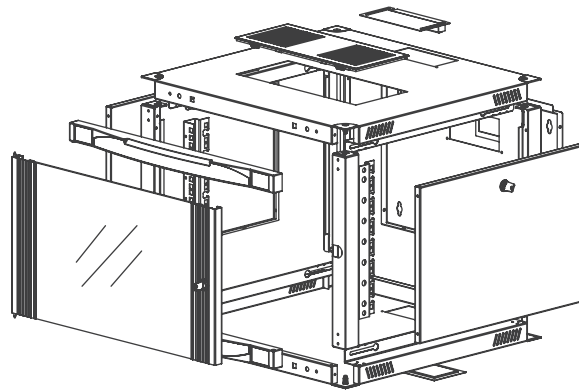

CONSTRUCTION  
DRAWING

EXPLODED VIEW

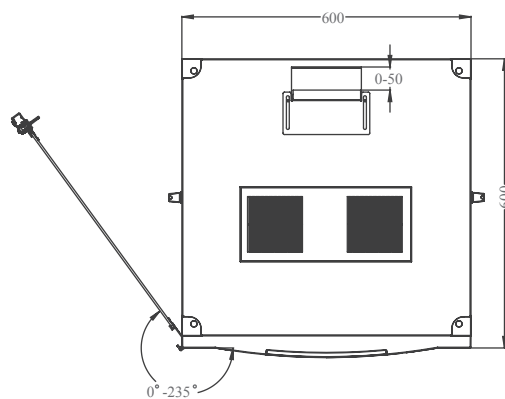
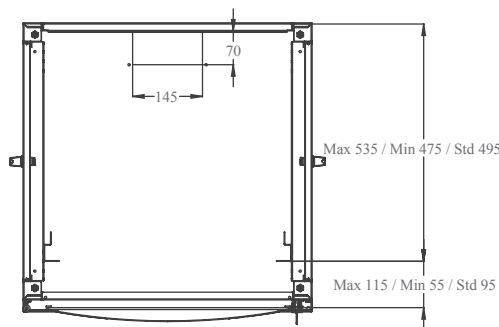
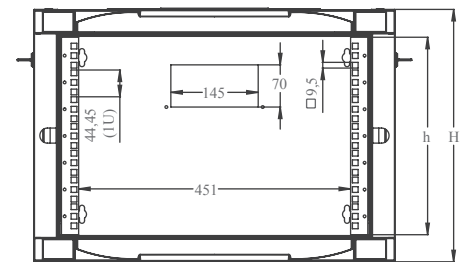
FRONT DOOR  
OPENING ANGLEMAX/STD/MIN EQUIPMENT  
MOUNTING DISTANCEDIMENSIONS IN  
WIDTH AND HEIGHT

NETbox Series Wall Mounting 19" Cabinets W=600mm D=600mm

ROOT Product Number ***	Product Description	Size WxDxH mm	h size in U	h in mm	*H mm, overall without feet and/or castor	Width Overall mm	Ah Wall Mounting h mm	Width Rail to Rail mm	Depth Overall mm	**Depth Shipping Conf. Rail to Rear Panel mm	QTY IN PACKAGE	PACKING DIMENSIONS WxDxH mm	Standard NET Weight of product kgs	Gross Weight of Product kgs	QTY IN PALETTE	PALETTE DIMENSIONS WxDxH mm	Palette Weight kgs
LN-WM07U6060-CC-111	7U 19" Wall Mounting Cabinet W=600mm D=600mm	600x600x423	7U	311	423	600	260	19"	600	495	1	620x620x450	18	19	20	1300x1300x2400	406
LN-WM09U6060-CC-111	9U 19" Wall Mounting Cabinet W=600mm D=600mm	600x600x512	9U	400	512	600	349	19"	600	495	1	620x620x540	20	21	16	1300X1300x2280	362
LN-WM12U6060-CC-111	12U 19" Wall Mounting Cabinet W=600mm D=600mm	600x600x646	12U	533	646	600	482	19"	600	495	1	620x620x670	24	25,3	12	1300X1300x2150	329
LN-WM16U6060-CC-111	16U 19" Wall Mounting Cabinet W=600mm D=600mm	600x600x824	16U	711	824	600	660	19"	600	495	1	620x620x850	28	29,5	10	1300X1300x2450	321
LN-WM20U6060-CC-111	20U 19" Wall Mounting Cabinet W=600mm D=600mm	600x600x1001	20U	889	1001	600	838	19"	600	495z	1	620x620x1030	32	33,7	8	1300X1300x2250	295

\* Please add 30mm to H mm once used with leveling feet, add 60mm to H mm once used with castor set.

\*\* See min and max Adjustable depth variations on drawings

\*\*\*CC= LG for Light Grey RAL 7035 &amp; BL for Black RAL 9005 for customers to define while ordering, for "111" selection please see the door options

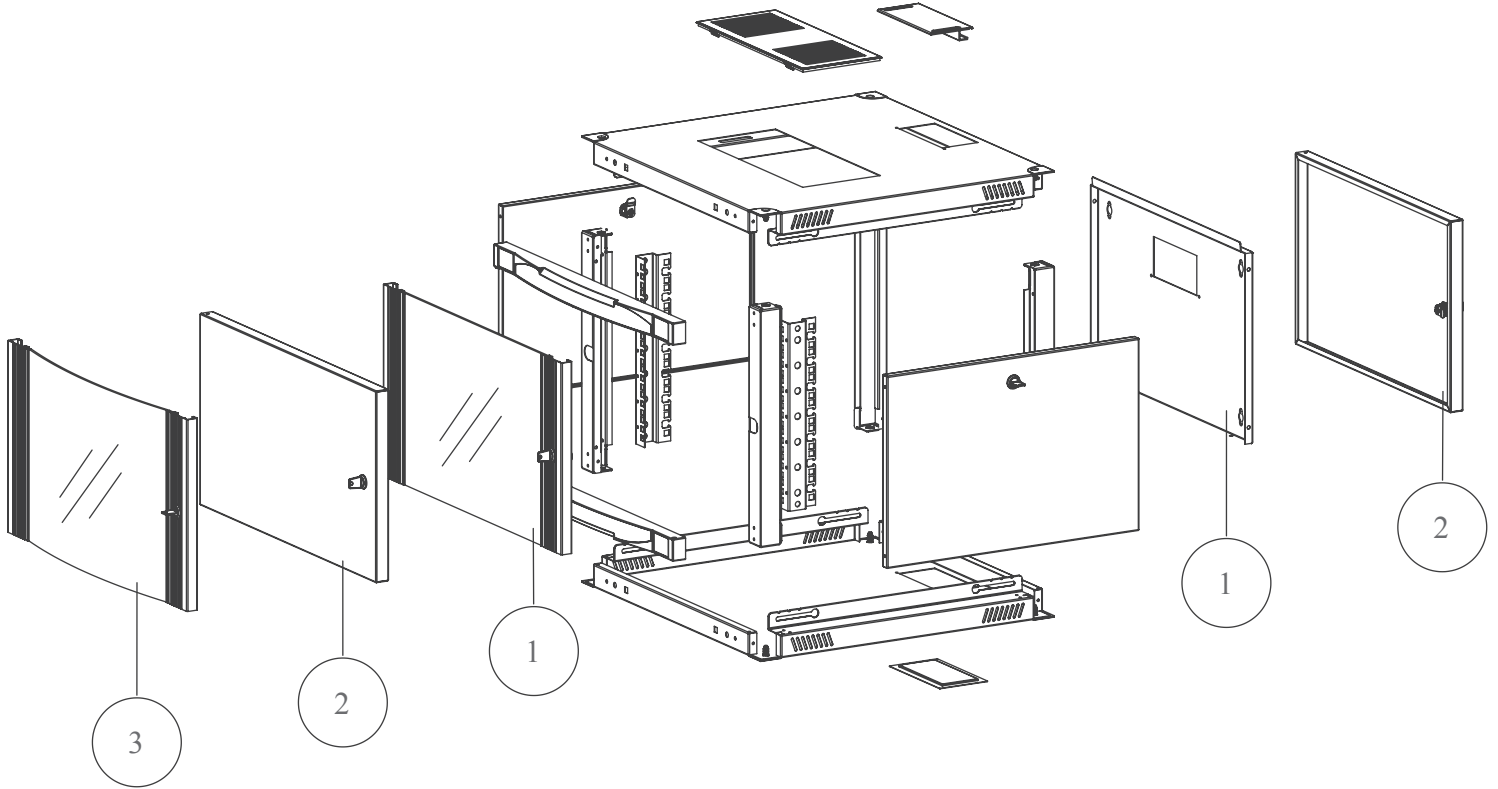
DOOR  
OPTIONS

NETbox Wall Mounting Cabinet W=600mm D=600mm  
All Heights FRONT DOOR Options

- 1 Single Opening, Flat Shape, Side Framed Glass Front Door, Single Point Barrel Locking.
- 2 Single Opening, Flat Shape, Complete Solid Metal Front Door, Single Point Barrel Locking
- 3 Single Opening, Curved Shape, Side Framed Glass Front Door, Single Point Barrel Locking.

NETbox Wall Mounting Cabinet W=600mm D=600mm  
All Heights REAR DOOR Options

- 1 Factory Configured Screwed and Mechanically Locked Rear Panel included
- 2 Hinged and barrel single point locking rear door

NETbox Wall Mounting Cabinet  
W=600mm D=600mm  
All Heights SIDE PANEL Options

- 1 NO Option, Factory Configured Side Panels are included

LN-AA

XXU

WW

DD

CC

LN Corporate codification beginning letters mentioning Lande in Short Format as LN

AA Family Group of Enclosure; FS for Free Standing cabinets, WM for Wall Mounting Cabinets, SH for Small office Home office Range, SR for Server enclosure Range, SL for Slim series, RS for Home series wall cabinets

XX Numeric Character defining the height of enclosures, depending on model differences between 12 to 45 to be selected from price list, website or catalogue

U U Height Alfanumeric Notation, concrete ( non editable- fixed character)

WW The First 2 digits of the width info, 60 for W=600mm, 80 for W=800mm, 54 for W=540mm, 30 for W=300mm Soho 10" enclosure

DD The First 2 digits of the depth info, 45 for D=450mm, 40 for D=400mm, 60 for D=600mm, 80 for D=800mm, 10 for D=1000mm cabinets

CC Color Code, LG for Light Grey RAL 7035, BL for Black RAL 9005

000

0 Front Door Variation number, numeric character 1 to 9 / 0 means no front door, standard front door defined in Lande System as option 1., Please select other variations if needed from above door selection drawing. Unless defined option 1 should be delivered

0 Rear Door Variation number, numeric character 1 to 9 / 0 means no rear door, standard rear door defined in Lande System as option 1., Please select other variations if needed from above door selection drawing. Unless defined option 1 should be delivered

0 Side Panel/Door Variation number, numeric character 1 to 9 / 0 means no side panel on product, standard side panel/door defined in Lande System as option 1. Unless defined option 1 should be delivered